

Ver. 1.0

# FCM Setting Guide

---

FCM setting guide document

Copyright © 2023. FNSVALUE. All rights reserved

Copying, reproducing, distributing, or using all or part of this content without prior approval from FNSVALUE is prohibited.

# Contents

## Table of Contents

- Create Firebase Admin SDK Key
- Add App

# Revision History

Version	Date of Change	Content	Modifier
v. 1.0	2023. 12. 15	First draft.	Choi Sooyoung

# Create Firebase Admin SDK Key

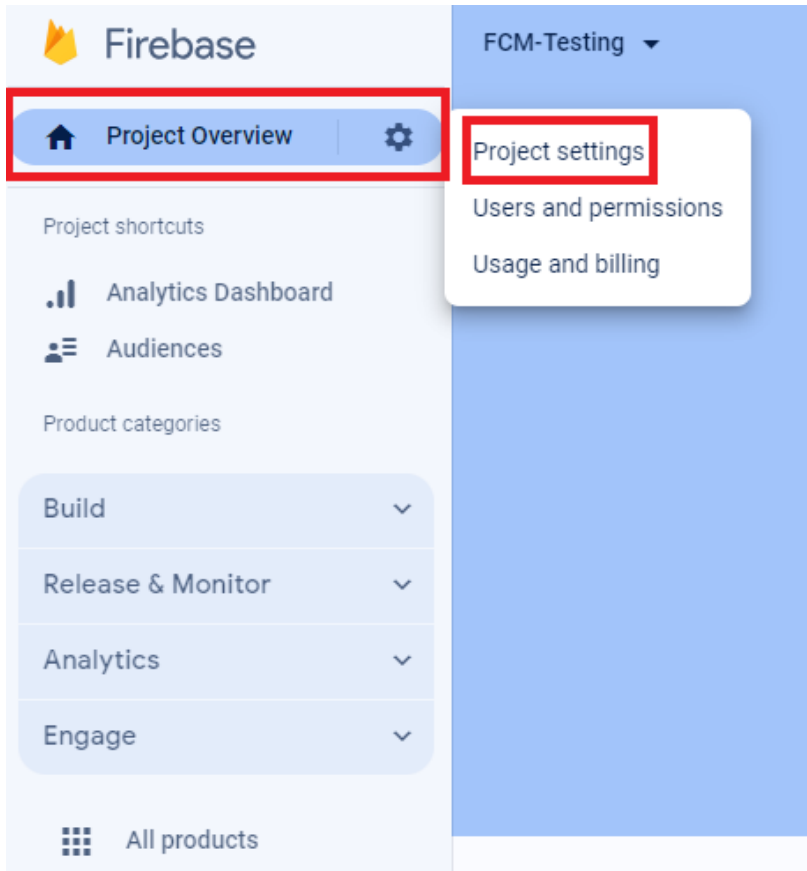

Please enter **[Project Overview]** > **[Project Settings]** of the FCM project in that order.

# Create Firebase Admin SDK Key

FCM-Testing ▾

## Project settings

General Cloud Messaging Integrations **Service accounts** Data privacy Users and permissions

[Manage service account permissions](#)

### Service accounts

- Legacy credentials
- Database secrets
- All service accounts
- 5 service accounts**

#### Service accounts

- Firebase Admin SDK**

Your Firebase service account can be used to authenticate multiple Firebase features, such as Database, Storage and Auth, programmatically via the unified Admin SDK. [Learn more](#)

Firestore service account  
firebase-adminsdk

Admin SDK configuration snippet

Node.js  Java  Python  Go

```
var admin = require("firebase-admin");  
  
var serviceAccount = require("path/to/serviceAccountKey.json");  
  
admin.initializeApp({  
  credential: admin.credential.cert(serviceAccount)  
});
```

[Generate new private key](#)

Please navigate to the **[Service accounts]** tab on the project settings screen.

Then, click the **[Generate New Private Key]** button under the **[Firebase Admin SDK]** section.

※ **(Important)** If you are already using Firebase Admin SDK in your FCM project, please provide the existing Firebase Admin SDK JSON file instead of generating a new private key.

# Create Firebase Admin SDK Key

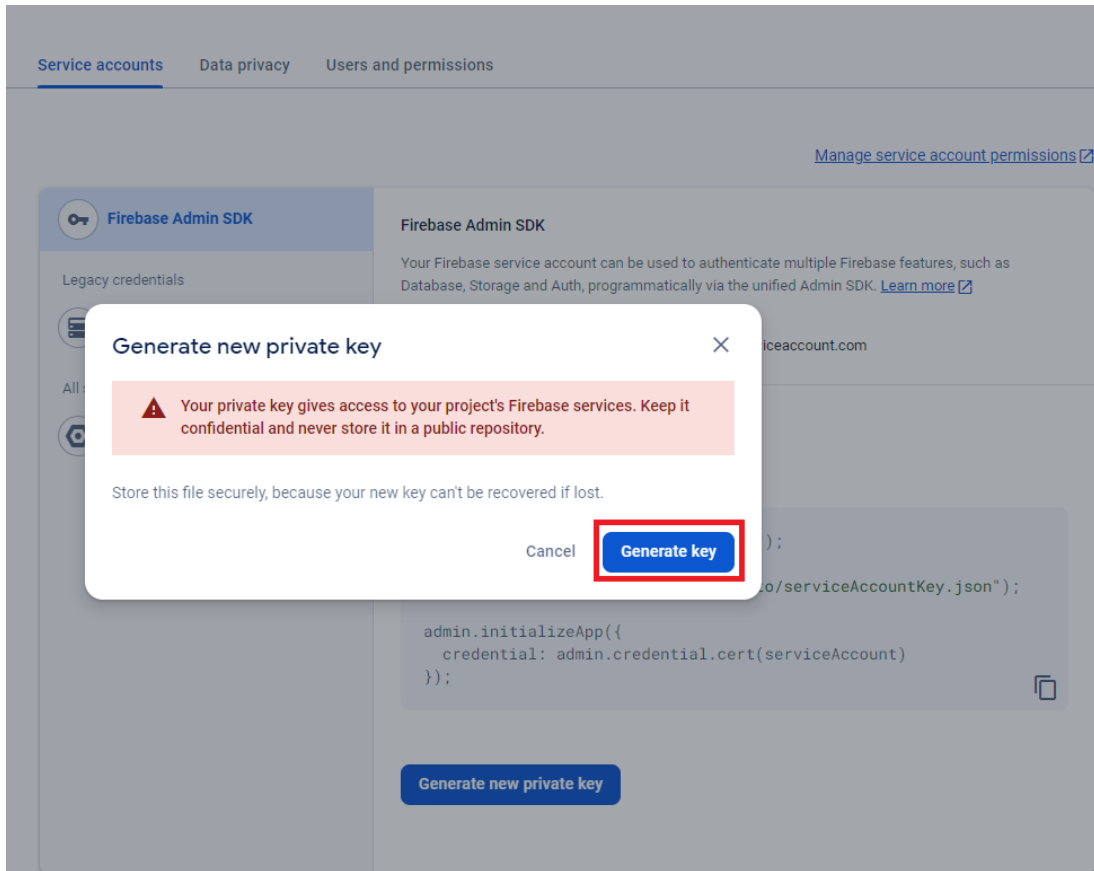

Please press [**Generate Key**] and send us the downloaded JSON file without changing its filename.

✂ If you were using an existing Firebase Admin SDK on the previous page, this step does not apply to you. Please proceed to the next step.

For more information related to Firebase Admin SDK, please refer to the following link.

[\[Link\]](#)

## Add App

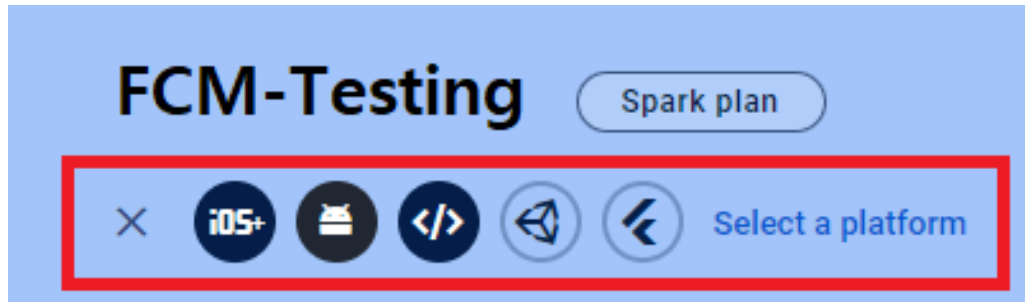
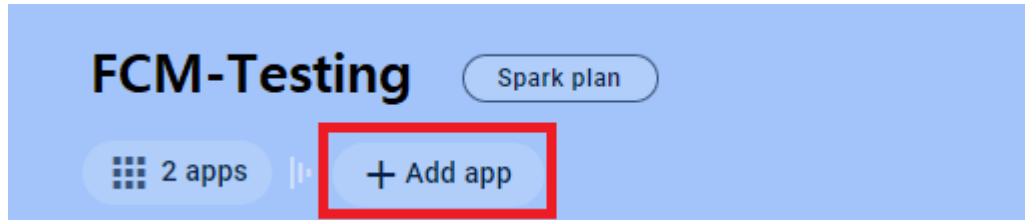

Please press the **[Add App]** button located at the top center of the project's main screen.

Afterwards, please select the platform of the client you want to add.

